



中物精密电器（上海）有限公司

CHUBUTSU PRECISE ELECTRONIC COMPANY LIMITED

MD250 Mid Drive USER MANUAL



中物精密电器（上海）有限公司

CHUBUTSU PRECISE ELECTRONIC COMPANY LIMITED

CATELOGUE



中物精密电器（上海）有限公司

CHUBUTSU PRECISE ELECTRONIC COMPANY LIMITED

1、 ABOUT USER MANUAL.....

.....

2、 MOTOR SPECS.....

.....

3、 FRAME WELDING.....

.....

4、 OUTLOOK AND SIZE.....

.....

5、 MOTOR ASSEMBLY STEPS.....

.....

6、 CONTROLLER CABLES DIAGARM.....

.....



中物精密电器（上海）有限公司

CHUBUTSU PRECISE ELECTRONIC COMPANY LIMITED

About the User Manual

Dear users,

To ensure better performance of your Mid Drive motor, please read through the MD250 product introduction carefully before using it. We will inform you all the details concisely when using our motor. Meanwhile, the introduction will also help you solve possible confusion and malfunction.

Motor Specs

For this Mid Drive motor , 36V and 48V are available with options of 250W and 350W. The MD250 generates an astounding 80NM maximum load torque, yet still achieves a peak efficiency of $\geq 80\%$. The speed can reach 25KM/H to 32KM/H, and the weight of the motor is less than 4.5KG. We can make some adjustments



中物精密电器（上海）有限公司

CHUBUTSU PRECISE ELECTRONIC COMPANY LIMITED

according to your requirements, such as the chain wheel(38T~52T) and the chain cover(chain cover and full chain cover).

Frame Welding

Refer to the attachment1 and 2, please.

中物精密电器（上海）有限公司

CHUBUTSU PRECISE ELECTRONIC COMPANY LIMITED

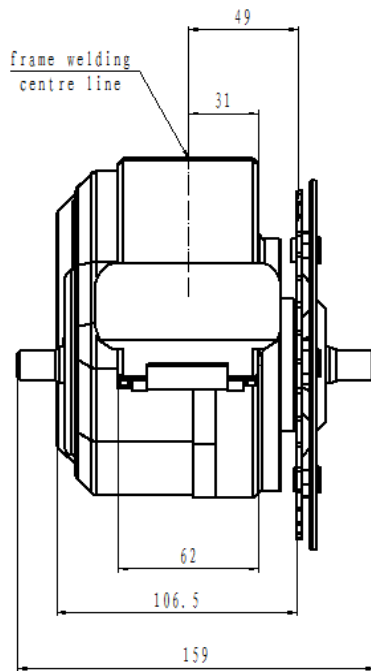

Attachment 1

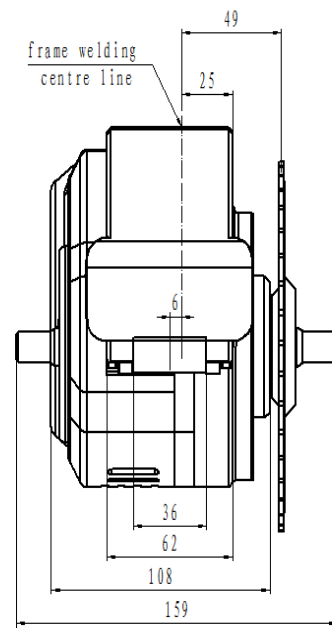

Attachment 2

Outlook and Size

中物精密电器（上海）有限公司

CHUBUTSU PRECISE ELECTRONIC COMPANY LIMITED

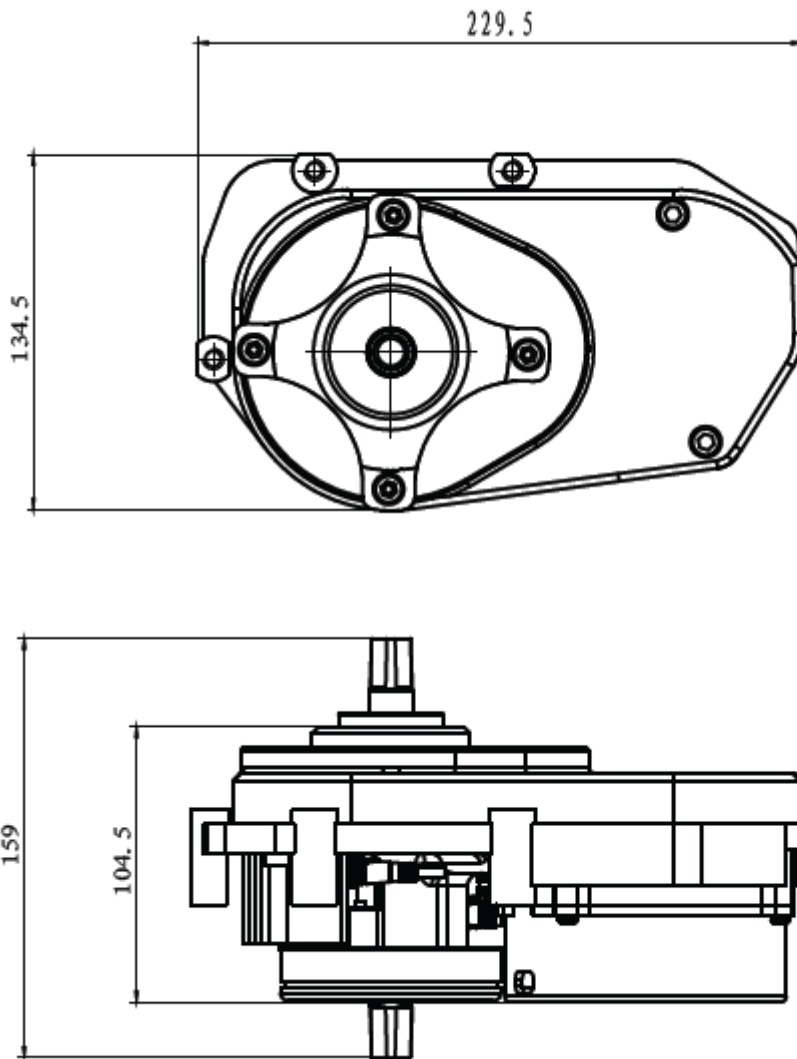

中物精密电器（上海）有限公司

CHUBUTSU PRECISE ELECTRONIC COMPANY LIMITED

Assembly steps

1、E-bike diagram

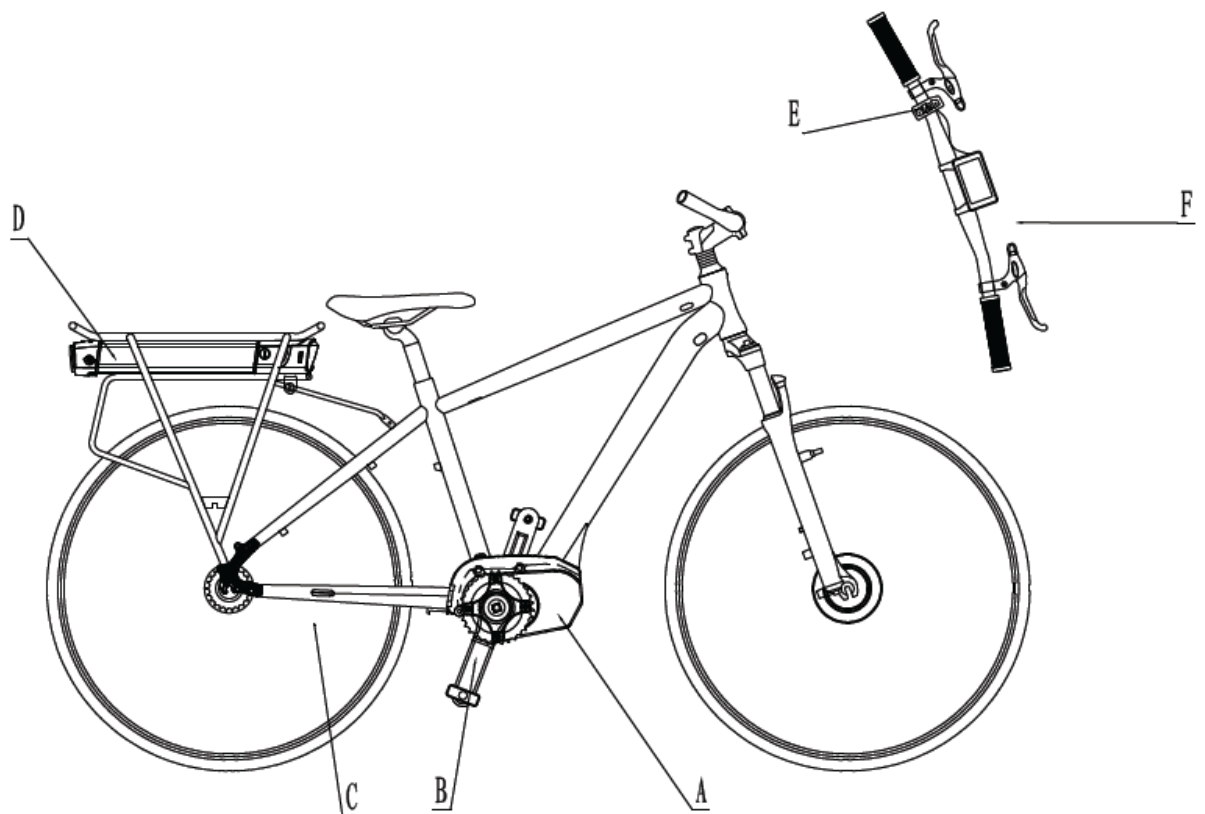



中物精密电器（上海）有限公司

CHUBUTSU PRECISE ELECTRONIC COMPANY LIMITED

A. Mid drive motor B. Crank C. Wheel speed sensor

D. Battery E. Switch F. LCD display

2、Motor Installation Diagram

中物精密电器（上海）有限公司

CHUBUTSU PRECISE ELECTRONIC COMPANY LIMITED

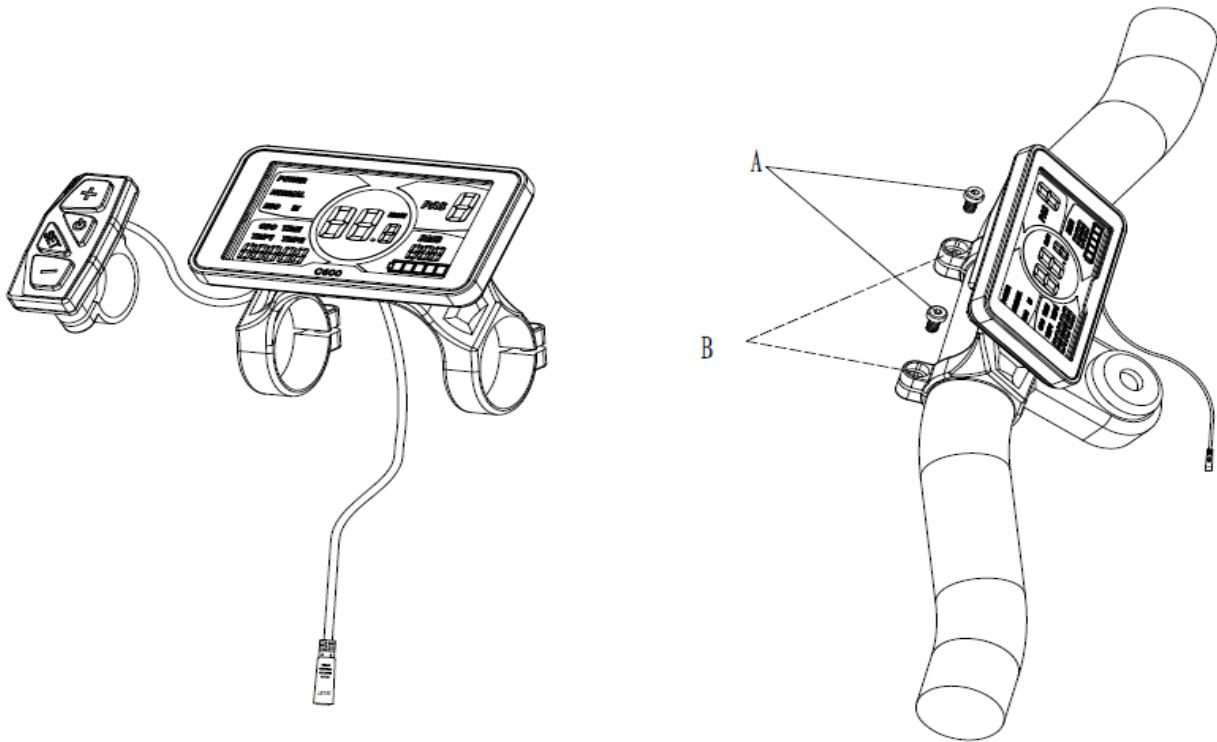

Display: LCD-P

First ,LCD dislay shoud be
buckled on the handle bar,
then insert two M4(A) bolts



中物精密电器（上海）有限公司

CHUBUTSU PRECISE ELECTRONIC COMPANY LIMITED

into the threaded holes(B)
separately.

Fastening torque: 1N.M

中物精密电器（上海）有限公司

CHUBUTSU PRECISE ELECTRONIC COMPANY LIMITED

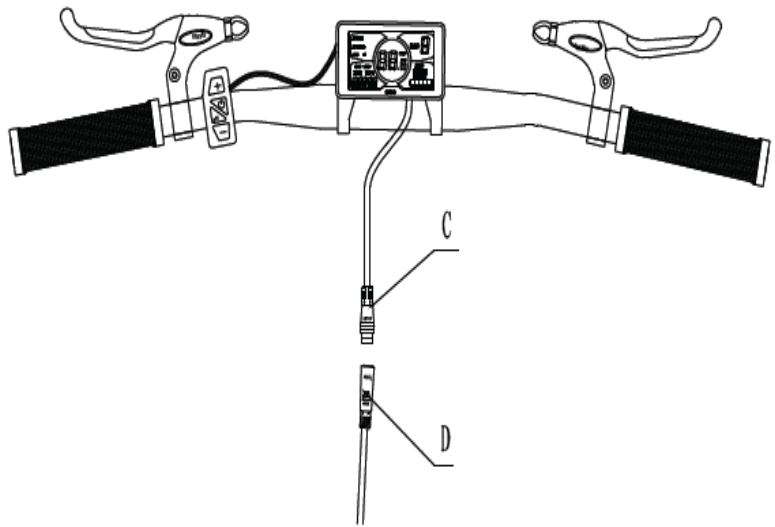
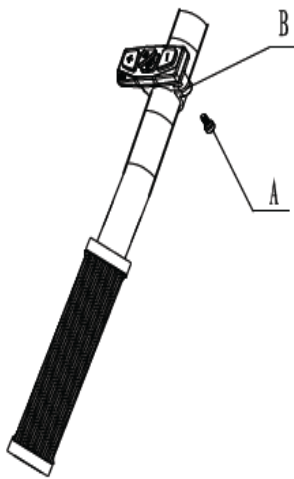

First ,the switch of diasplay shoud be
buckled on the handle bar, then insert

When the display and switch are
installed, link the cable C to cable



中物精密电器（上海）有限公司

CHUBUTSU PRECISE ELECTRONIC COMPANY LIMITED

two M4(A) bolts into the threaded

D.

holes(B) separately.

Fastening torque: 1N.M

中物精密电器（上海）有限公司

CHUBUTSU PRECISE ELECTRONIC COMPANY LIMITED

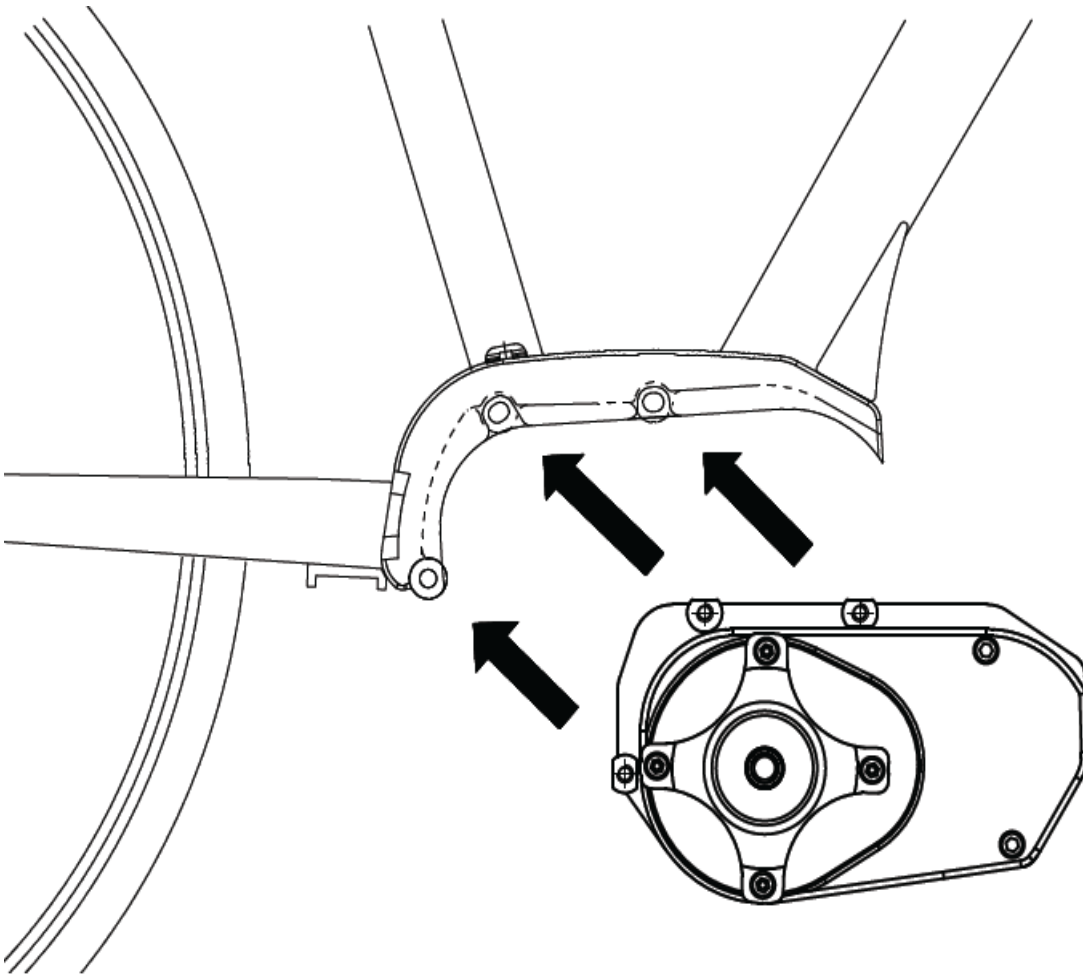

Align the mounting holes of the Mid Drive motor with the mounting holes in the



中物精密电器（上海）有限公司

CHUBUTSU PRECISE ELECTRONIC COMPANY LIMITED

bicycle frame.

中物精密电器（上海）有限公司

CHUBUTSU PRECISE ELECTRONIC COMPANY LIMITED

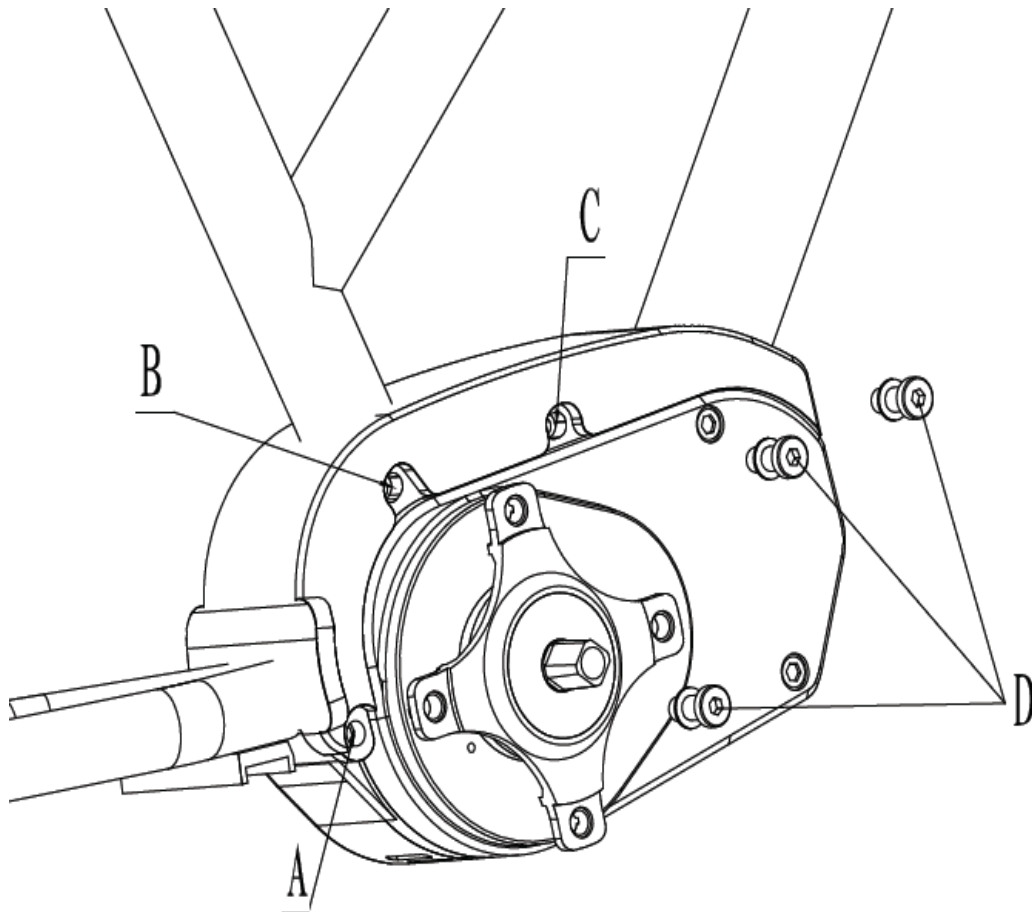

Insert special M8*20 nuts and flange gaskets into the mounting holes in the bicycle frame.

NOTE: Do not lock too tight firstly.



中物精密电器（上海）有限公司

CHUBUTSU PRECISE ELECTRONIC COMPANY LIMITED

中物精密电器（上海）有限公司

CHUBUTSU PRECISE ELECTRONIC COMPANY LIMITED

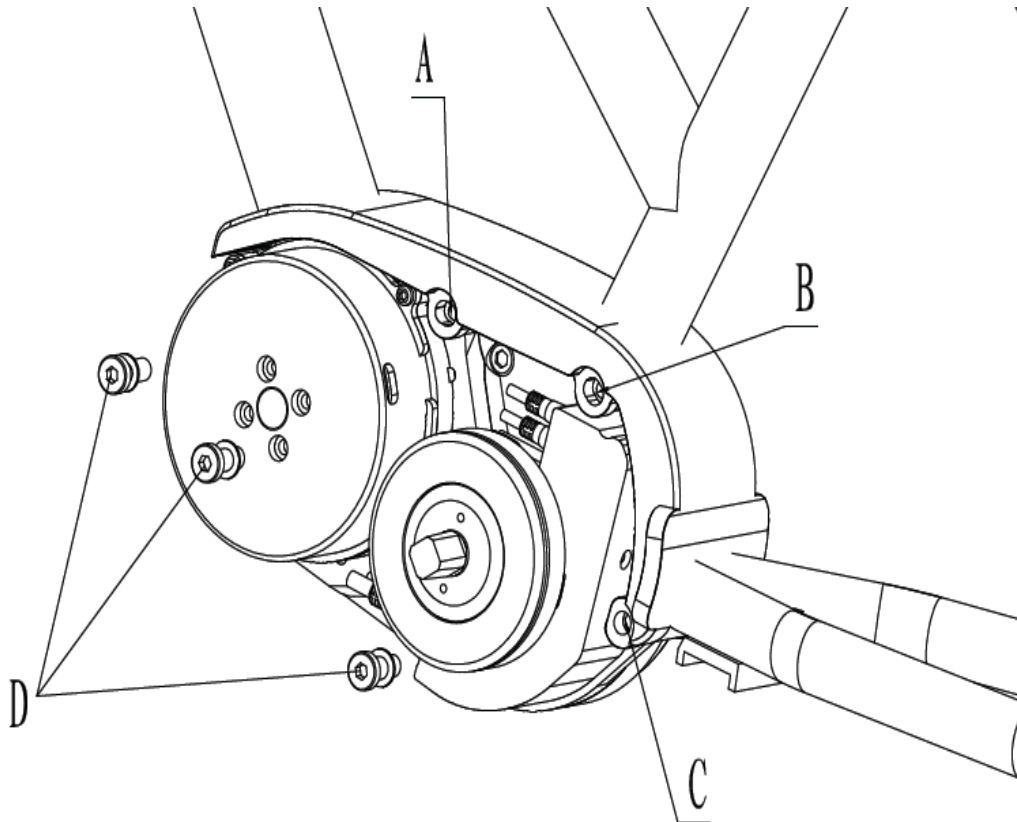

Insert three M8 bolts(D) and flange gaskets into the bicycle frame(A,B,C) so they can come to contact with the nuts,and then tighten bolts onto nuts.

Tightening torque:18~20N.M

中物精密电器（上海）有限公司

CHUBUTSU PRECISE ELECTRONIC COMPANY LIMITED

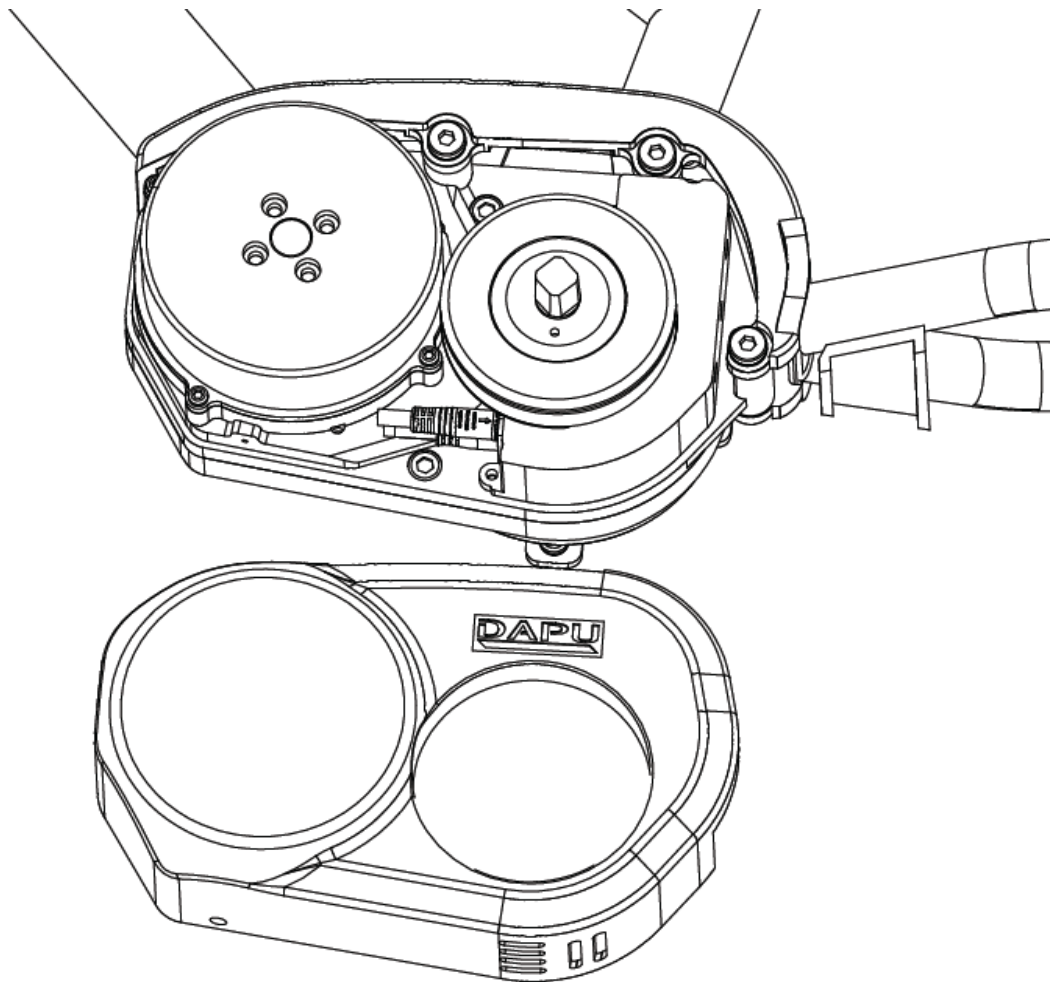



中物精密电器（上海）有限公司

CHUBUTSU PRECISE ELECTRONIC COMPANY LIMITED

Install the motor cover onto the Mid Drive unit. First, motor cover should be buckled on the Mid Drive unit based on the sensor cover external diameter, then align the two counterbored holes of the motor cover with the two threaded holes on the Mid Drive unit.

中物精密电器（上海）有限公司

CHUBUTSU PRECISE ELECTRONIC COMPANY LIMITED

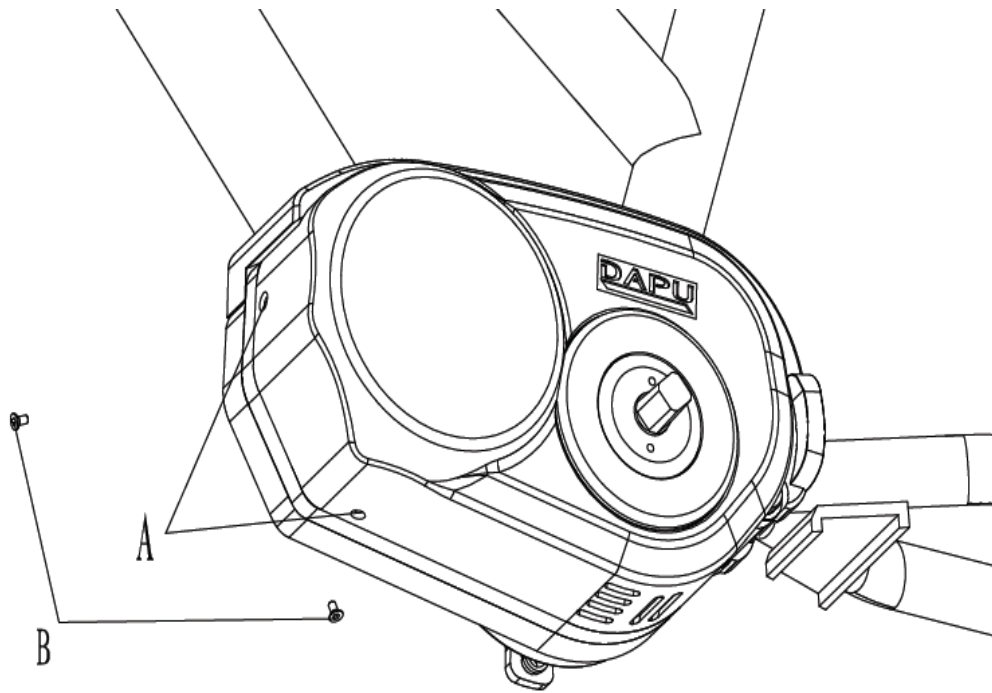

Insert two chamfer head screws M3*6 into the threaded holes of the motor.

Fastening torque:1~2N.M

中物精密电器（上海）有限公司

CHUBUTSU PRECISE ELECTRONIC COMPANY LIMITED

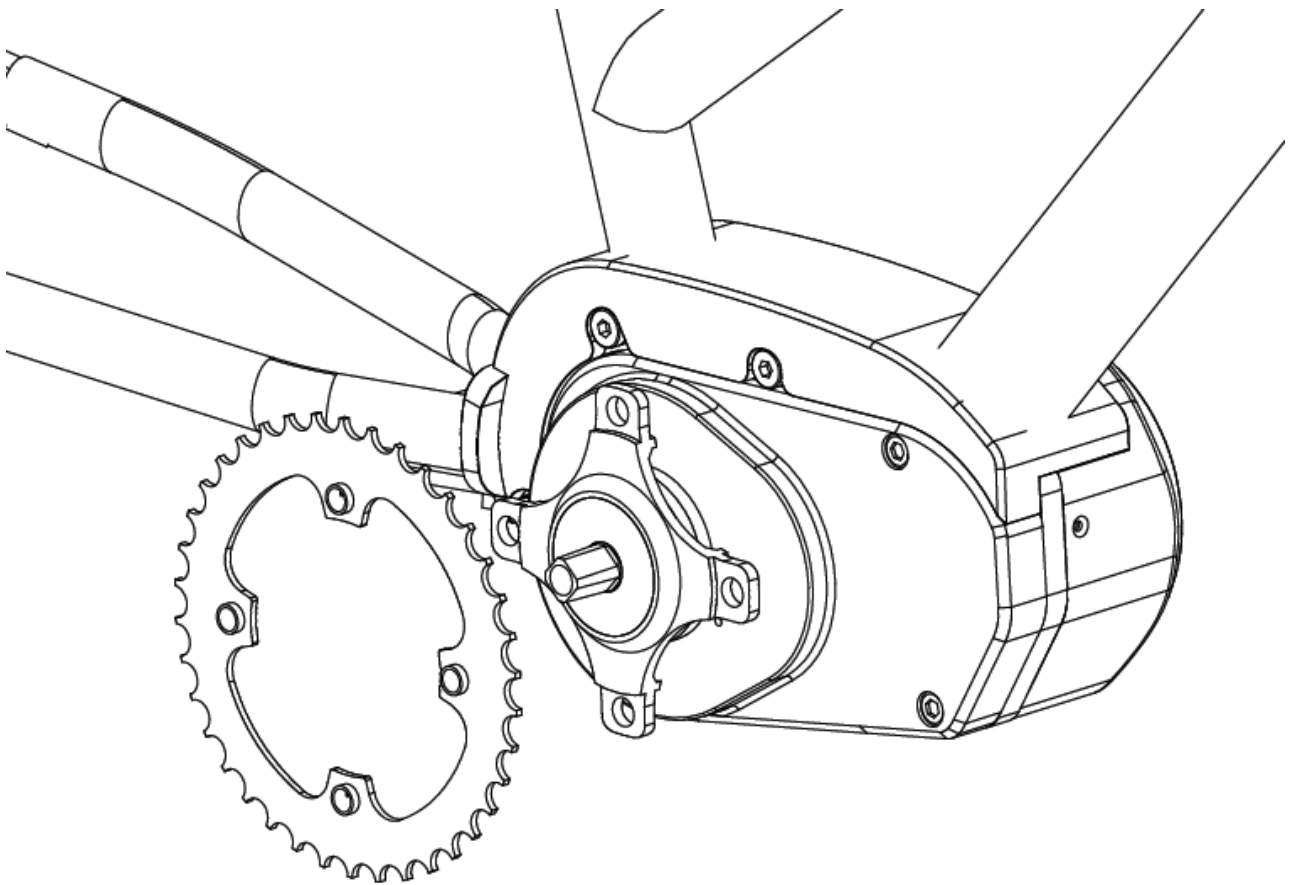



中物精密电器（上海）有限公司

CHUBUTSU PRECISE ELECTRONIC COMPANY LIMITED

Install the chain wheel and the hollow screws onto the inner side of the capstan, and the four holes of chain wheel should be aligned with the holes of capstan.

中物精密电器（上海）有限公司

CHUBUTSU PRECISE ELECTRONIC COMPANY LIMITED

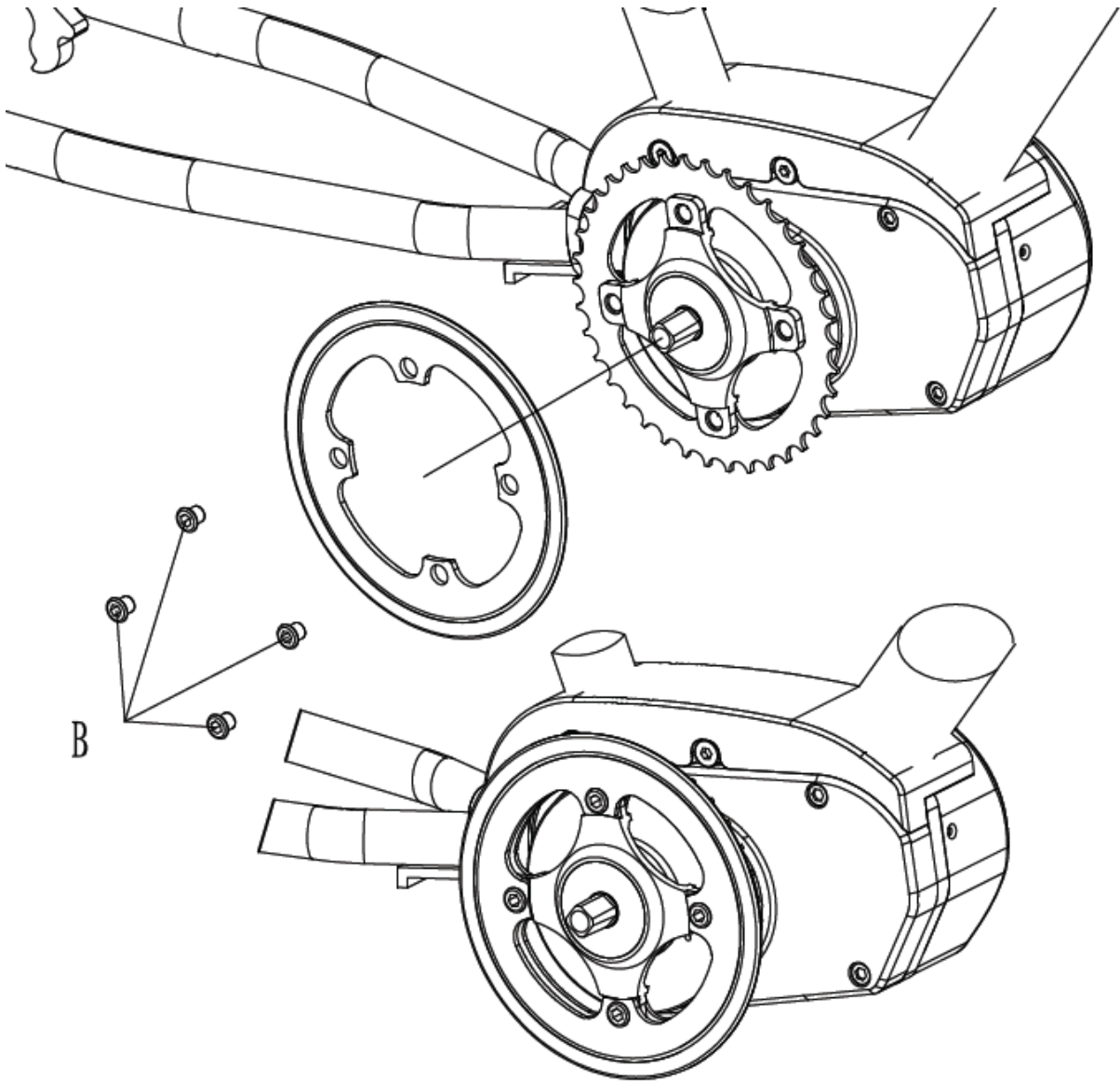

Install the chain guard onto the capstan, then insert four hollow screws(B) into



中物精密电器（上海）有限公司

CHUBUTSU PRECISE ELECTRONIC COMPANY LIMITED

the four hollow nuts,and lock tightly.

中物精密电器（上海）有限公司

CHUBUTSU PRECISE ELECTRONIC COMPANY LIMITED

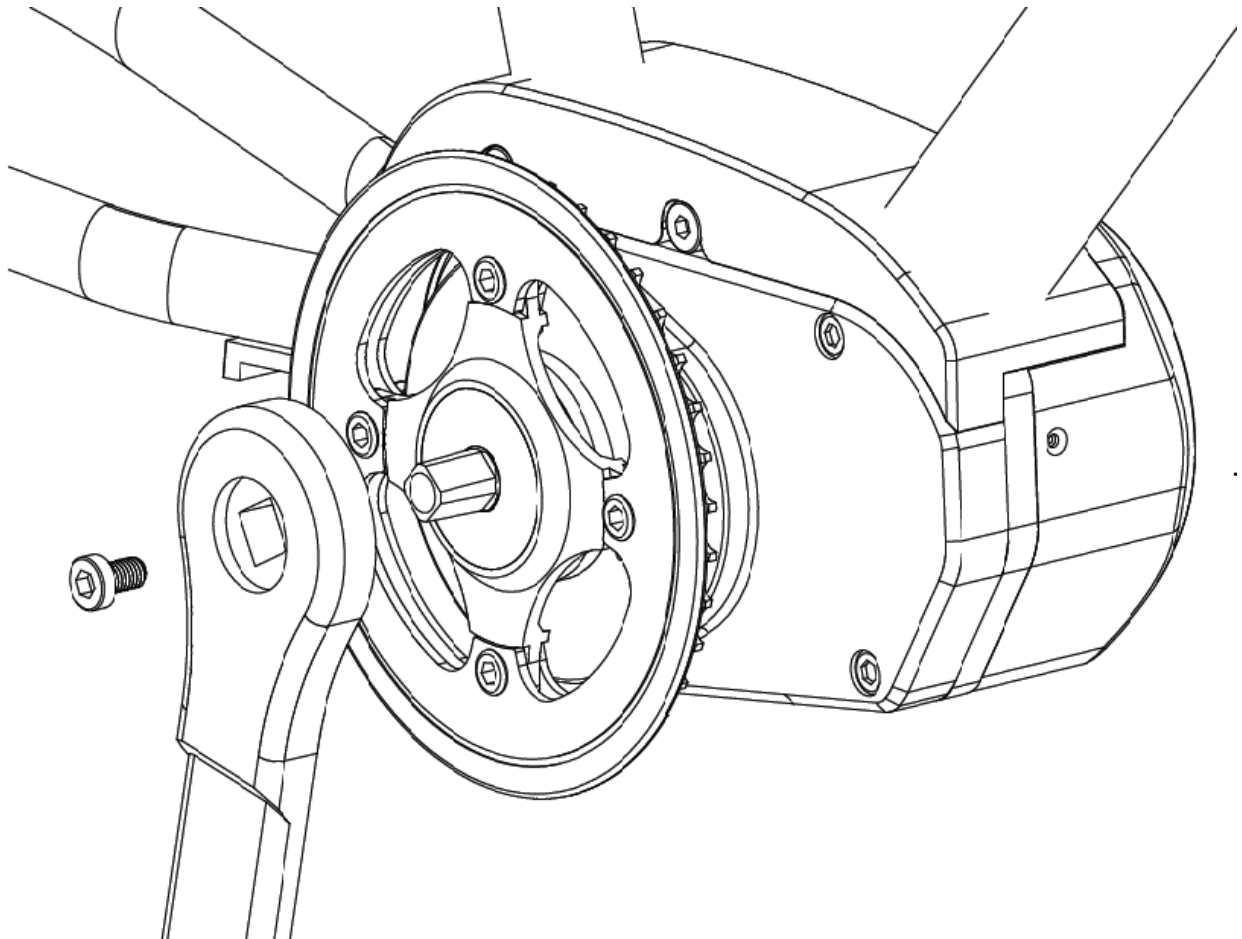

Fasten the crank onto the bottom bracket with a socket head .



中物精密电器（上海）有限公司

CHUBUTSU PRECISE ELECTRONIC COMPANY LIMITED

Controller Cables Diagram

中物精密电器（上海）有限公司

CHUBUTSU PRECISE ELECTRONIC COMPANY LIMITED

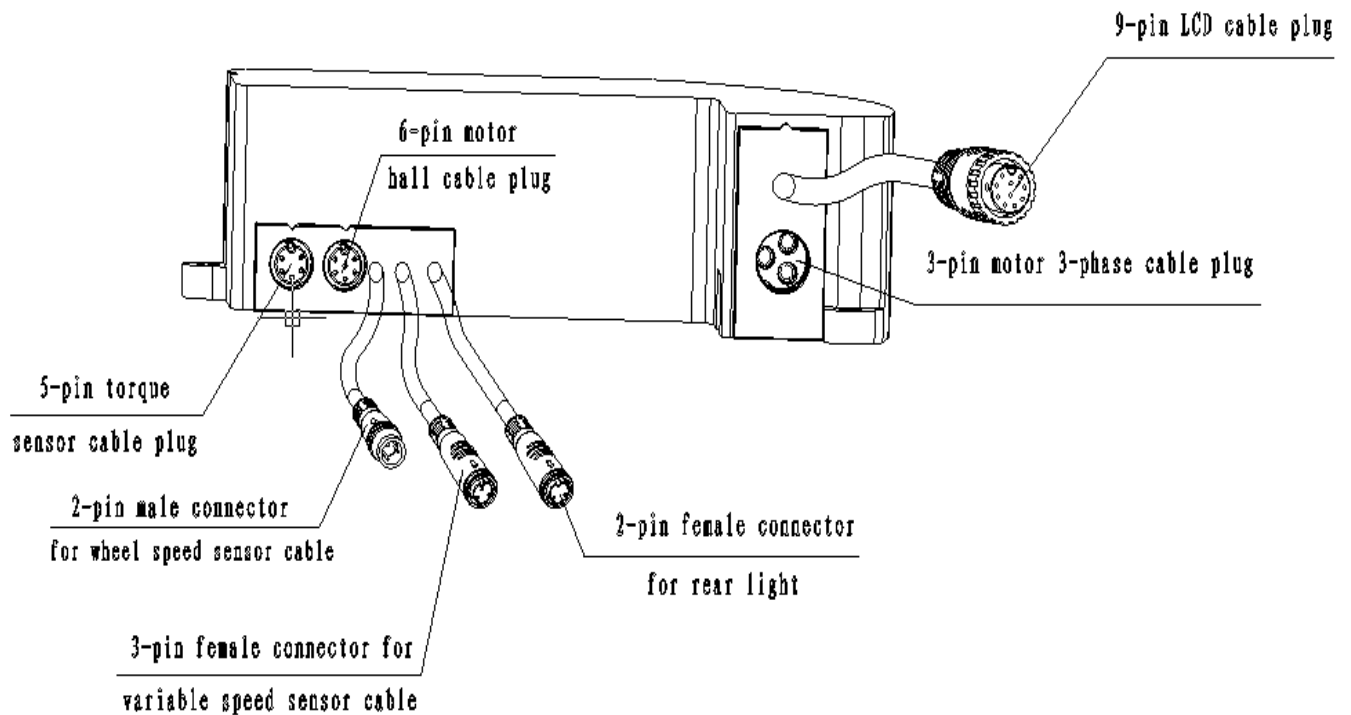

中物精密电器（上海）有限公司

CHUBUTSU PRECISE ELECTRONIC COMPANY LIMITED

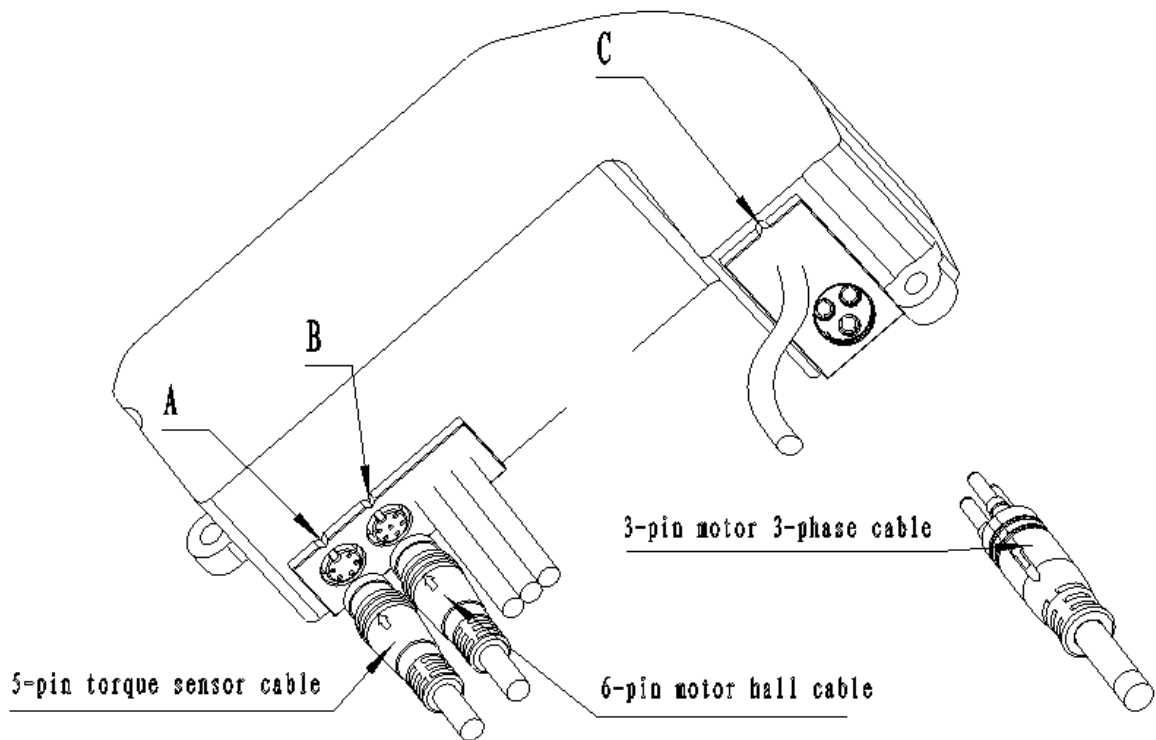



中物精密电器（上海）有限公司

CHUBUTSU PRECISE ELECTRONIC COMPANY LIMITED

Plug the 5-pin torque sensor cable, 6-pin motor hall cable and 3-pin motor 3-phase cable respectively into the corresponding plug.

NOTE: Align the “” with the mark “V”(A,B,C)

中物精密电器（上海）有限公司

CHUBUTSU PRECISE ELECTRONIC COMPANY LIMITED

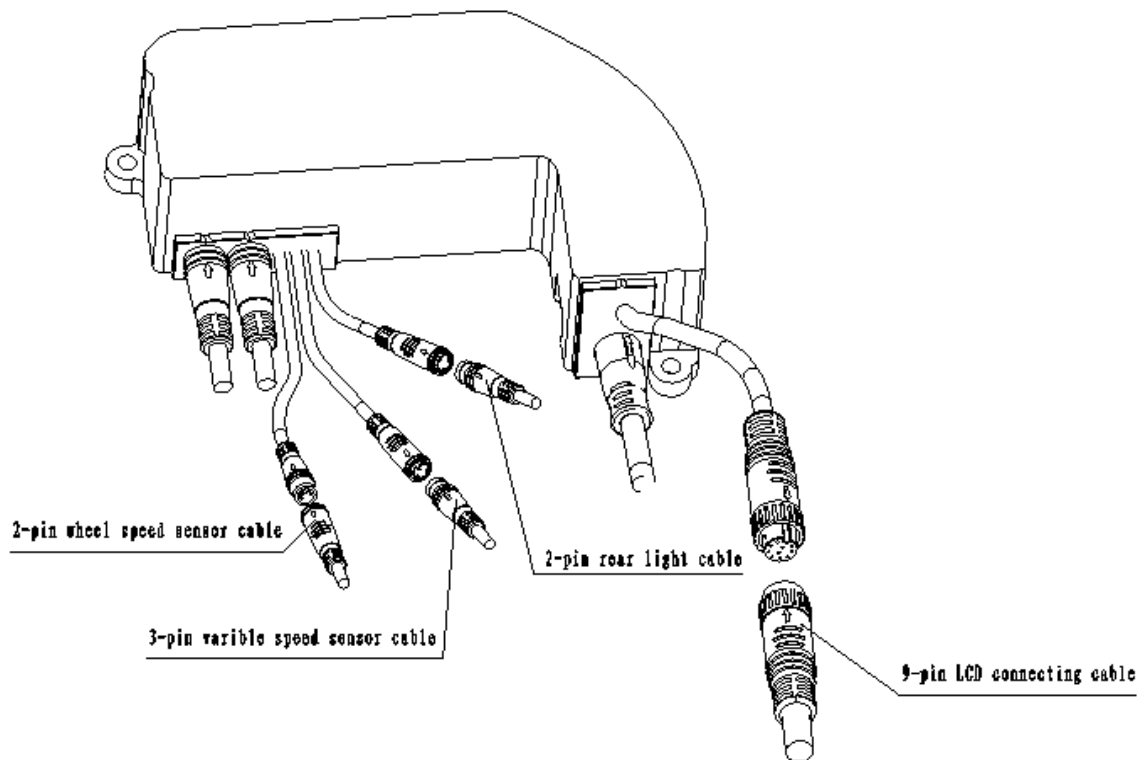

- 1.Link the female connector at the wheel speed sensor to the male connector for wheel speed sensor cable at the controller unit;
 - 2.Link the male connector at the variable speed sensor to the female connector for the variable speed sensor cable at the controller unit;
-

中物精密电器（上海）有限公司

CHUBUTSU PRECISE ELECTRONIC COMPANY LIMITED

3. Link the male connect at the rear light cable to the female connector for the rear light cable at the controller unit;
- 4.Link the male connector at the display connecting cable to the female connector at the contrller unit.

NOTE: Align the “  ” on the connectors.

中物精密电器（上海）有限公司

CHUBUTSU PRECISE ELECTRONIC COMPANY LIMITED

