

BIKEYOKE DIVINE

POS	part name	qty.
1	saddle clamp nut	2
2	upper saddle clamp	1
3	saddle clamp bolt	2
4	lower saddle clamp	1
5	valve cap	1
6	valve core	1
7	valve housing	1
8	upper tube unit	1
9	o-ring 16x2.5	1
10	main piston	1
11	o-ring 2.5x1.5	2
12	main valve	1
13	piston shaft	1
14	oring 17x2	1
15	shaft bushing	1
16	cartridge seal head	1
17	u-cup seal	1
18	actuator rod	1
19	wiper	1
20	upper bushing	1
21	lower tube	1
22	guiding pins	6
23	lower bushing	1
24	circlip	1
25	o-ring 18x3.5	1
26	foam cover ring	1
27	o-ring 24x2	1
28	o-ring 4x1	1
29	rod cap	1
30	actuator housing	1
31	circlip	1
32	actuator lever	1
33	spring pin 3x10	1

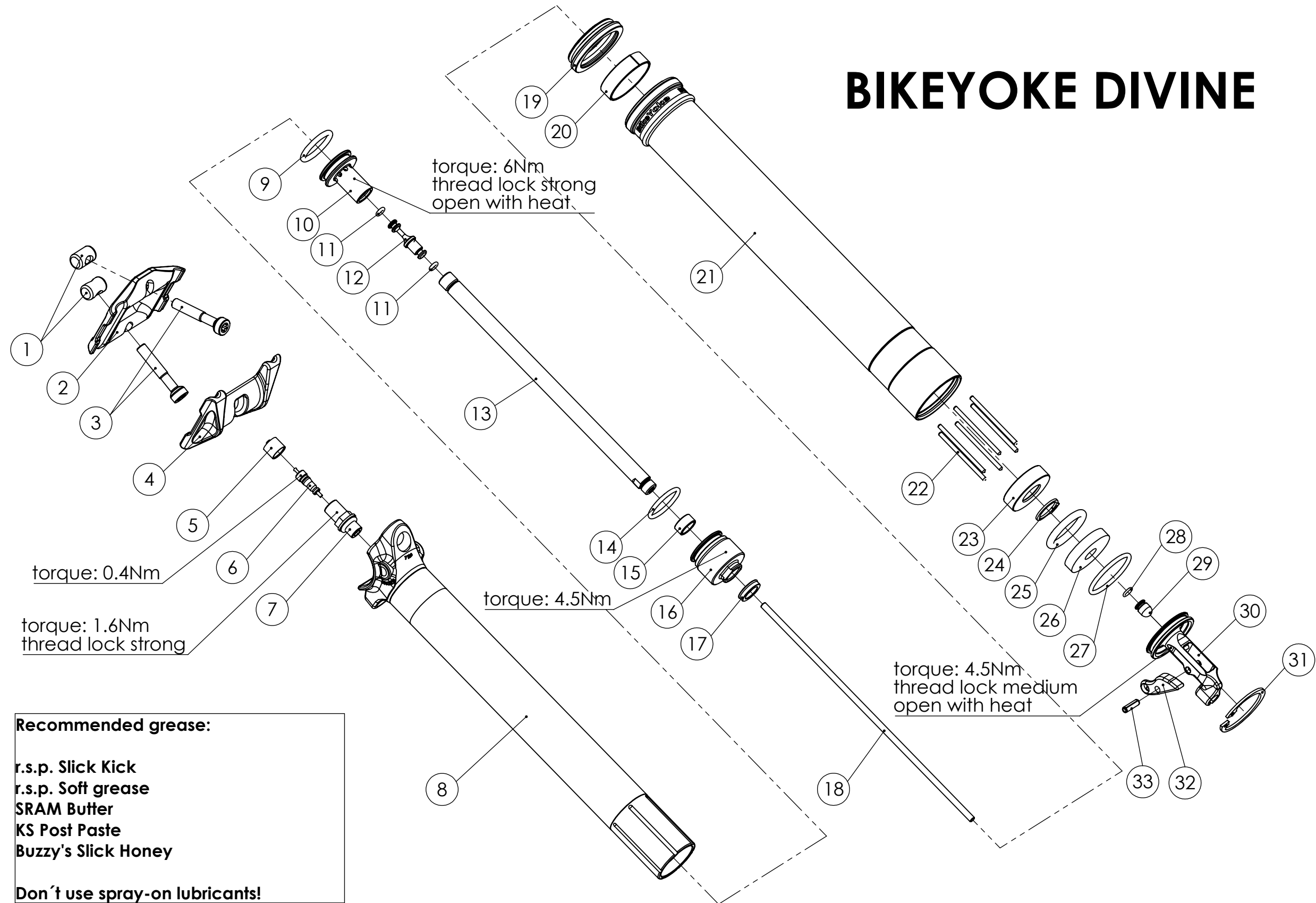

Recommended grease:
 r.s.p. Slick Kick
 r.s.p. Soft grease
 SRAM Butter
 KS Post Paste
 Buzzy's Slick Honey

Don't use spray-on lubricants!

Cartridge fluid volumes:
 125mm = 42.5ml
 160mm = 54.5ml
 185mm = 63ml

**BikeYoke recommends 96% Mobil DTE 10 Excel 15 with 4% r.s.p. No Stick Slip.
 Other suspension oils with similar viscosity will work, but may differ in performance.**